

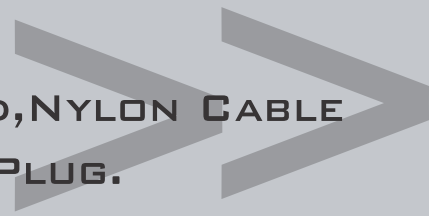

Product Overview Cable Glands



METAL CABLE GLAND, NYLON CABLE
GLAND & AIR VENT PLUG.





- Material: Brass, Nickel plated
- Plastic Material: PA66
- Sealing Material: Silicon
- IP Grade: Clamping range, O-Ring, IP68
- Temperature Limited: Limited: -40 °C -100 °C, 120 °C for short term
- Products Feature: Connecting more closer with O-Ring and more securer with entire rubber seal

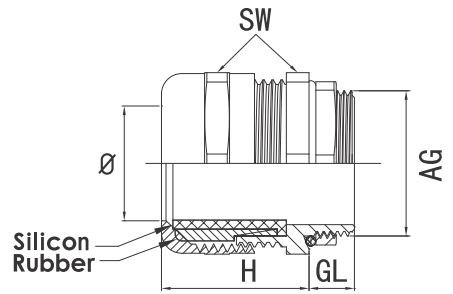

Thread Spec.	Material	Cable range (Ø)	Thread OD (AG)	Thread Length (GL)	Assembly Height (H)	Wrench size (SW)	Reference
M12×1.5	CU	3-6.5	12	7	19	14	9HT RSKM-M12A-C-OM
M16×1.5	CU	4-8	16	7	21	20	9HT RSKM-M16A-C-OM
M20×1.5	CU	6-12	20	8	22	24	9HT RSKM-M20A-C-OM
M25×1.5	CU	9-16	25	8	26	30	9HT RSKM-M25A-C-OM
M32×1.5	CU	18-25	32	10	31	40	9HT RSKM-M32A-C-OM
M40×1.5	CU	22-32	40	10	37	50	9HT RSKM-M40A-C-OM
M50×1.5	CU	32-38	50	11	37	55	9HT RSKM-M50A-C-OM
M63×1.5	CU	37-44	63	11	38	67	9HT RSKM-M50A-C-OM

Note:

1) Made under OEM arrangement by reputable cable gland manufacturer



- Material : PA6 V-2 Acc. To UL94 Flammability Class
- Sealing Material: EPDM
- IP Grade: clamping range , O-ring , IP68
- Temperature Limited: -40 C-100 C , short- term120 C
- Products Feature: Connection is more smoothly & closely with double-thread & O-ring groove. Protect connection by using improved protective sealings

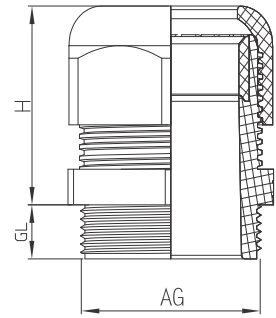

Thread Spec. Specification	RAL7035 Color	Cable range	Thread OD (AG)	Thread Length (GL)	Height (H)	Spanner	Reference
M12A×1.5	Grey	3-6.5	12	8	21	15	9HT RSKP-M12A-GY-PA6-PM
M16A×1.5	Grey	4-8	16	8	22	19	9HT RSKP-M16A-GY-PA6-PM
M20A×1.5	Grey	6-12	20	9	27	24	9HT RSKP-M20A-GY-PA6-PM
M25A×1.5	Grey	13-18	25	11	31	33	9HT RSKP-M25A-GY-PA6-PM
M32A×1.5	Grey	18-25	32	11	39	42	9HT RSKP-M32A-GY-PA6-PM
M40A×1.5	Grey	22-32	40	13	48	53	9HT RSKP-M40A-GY-PA6-PM
M50A×1.5	Grey	32-38	50	15	49	60	9HT RSKP-M50A-GY-PA6-PM
M63A×1.5	Grey	37-44	63	15	49	65/68	9HT RSKP-M63A-GY-PA6-PM

Note:

1) Made under OEM arrangement by reputable cable gland manufacturer



- Classification of Hazardous Areas: Exe /Zone 1 and 2 / IIC
- Material: Brass,Nickel plated
- Plastic Material: PA66
- Sealing Material: Silicon
- IP Grade: Clamping range, O-Ring, IP68
- Temperature Limited: Limited: -40 C -100 C ,120 C

for short term

- Products Feature:Connecting more closer with O-Ring and more securer with entire rubber seal

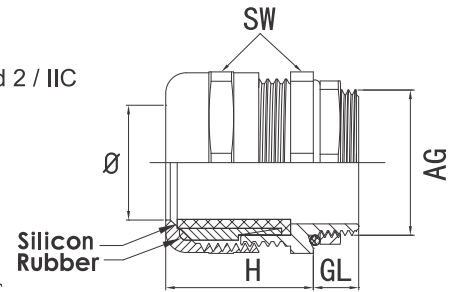

Thread Spec.	Material	Cable range (Ø)	Thread OD (AG)	Thread Length (GL)	Assembly Height (H)	Wrench size (SW)	Reference
M16A×1.5	CU	4-8	16	15	22	20	9HT RSKM-M16A-EX-LC-OM
M20A×1.5	CU	6-12	20	15	24	24	9HT RSKM-M20A-EX-LC-OM
M25A×1.5	CU	13-18	25	15	26	30	9HT RSKM-M25A-EX-LC-OM
M32A×1.5	CU	18-25	32	15	32	40	9HT RSKM-M32A-EX-LC-OM
M40A×1.5	CU	22-32	40	15	38	50	9HT RSKM-M40A-EX-LC-OM
M50A×1.5	CU	32-38	50	15	49	55	9HT RSKM-M50A-EX-LC-OM

Note:

1) Made under OEM arrangement by reputable cable gland manufacturer



- Classification of Hazardous Areas: Exe /Zone 1 and 2 / IIC
- Material : PA66,V-0 Acc. To UL94 Flammability Class
- Sealing Material: EPDM
- IP Grade: clamping range , O-ring, IP68
- Temperature Limited: -40 C-100 C , short- term120 C
- Products Feature: Connecting more smoothly & closely with double-thread & O-ring groove. Protecting connection safe by using improved protective sealings

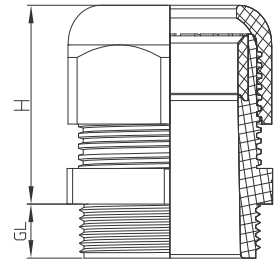

Thread Spec. Specification	RAL9005 Color	Cable range	Thread OD (AG)	Thread Length (GL)	Height (H)	Spanner	Reference
M16A×1.5	Black	4-8	16	15	22	19	9HT RSKP-M16A-EX-L-BL-PA6-PM
M20A×1.5	Black	6-12	20	15	27	24	9HT RSKP-M20A-EX-L-BL-PA6-PM
M25A×1.5	Black	13-18	25	15	31	33	9HT RSKP-M25A-EX-L-BL-PA6-PM
M32A×1.5	Black	18-25	32	15	39	42	9HT RSKP-M32A-EX-L-BL-PA6-PM
M40A×1.5	Black	22-32	40	18	48	53	9HT RSKP-M40A-EX-L-BL-PA6-PM
M50A×1.5	Black	32-38	50	18	49	60	9HT RSKP-M50A-EX-L-BL-PA6-PM
M63A×1.5	Black	37-44	63	18	49	65/68	9HT RSKP-M63A-EX-L-BL-PA6-PM

Note:

1) Made under OEM arrangement by reputable cable gland manufacturer

RPK-M Nylon Grey Screw Plug + Nut 1)

Thread Specification	Material Grey RAL7035	(AG) mm	(D) mm	(H) mm	Reference (without nut)	Reference (with nut)
M12×1.5	Nylon PA6	12	16	8	9HT RPK-M12-GY	9HT RPK-M12-GY-M
M16×1.5	Nylon PA6	16	20	8	9HT RPK-M16-GY	9HT RPK-M16-GY-M
M20×1.5	Nylon PA6	20	25	9	9HT RPK-M20-GY	9HT RPK-M20-GY-M
M25×1.5	Nylon PA6	25	30	11	9HT RPK-M25-GY	9HT RPK-M25-GY-M
M32×1.5	Nylon PA6	32	39	11	9HT RPK-M32-GY	9HT RPK-M32-GY-M
M40×1.5	Nylon PA6	40	46	13	9HT RPK-M40-GY	9HT RPK-M40-GY-M
M50×1.5	Nylon PA6	50	57	15	9HT RPK-M50-GY	9HT RPK-M50-GY-M
M63×1.5	Nylon PA6	63	70	15	9HT RPK-M63-GY	9HT RPK-M63-GY-M



RPK-M

- Material : PA Material, V2 , Acc. to UL94
- Color: Black (BL) & Grey (GY)
- IP Grade: O-ring, IP68
- Temperature Limited: -40 C -100 C
- ProductsFeatures:Non-halogen,non-phosphor, non-cadmium.approved by ROHS

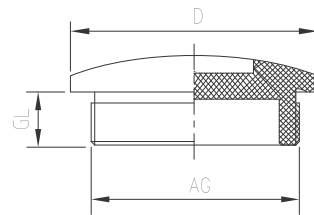

RPM-M Nickel Plated Brass Screw Plug+ Nut 1)

Thread Specification	(AG) mm	(L1) mm	(H) mm	(D) mm	Wench Size (SW)	Reference (without nut)	Reference (with nut)
M12×1.5	12	6	9	14	14	9HT RPM.C-M12-C	9HT RPM.C-M12-C-OM
M16×1.5	16	7	10	18	20	9HT RPM.C-M16-C	9HT RPM.C-M16-C-OM
M20×1.5	20	7	10	23	24	9HT RPM.C-M20-C	9HT RPM.C-M20-C-OM
M25×1.5	25	7	10	28	30	9HT RPM.C-M25-C	9HT RPM.C-M25-C-OM
M32×1.5	32	8	12	35	40	9HT RPM.C-M32-C	9HT RPM.C-M32-C-OM
M40×1.5	40	9	12	44	50	9HT RPM.C-M40-C	9HT RPM.C-M40-C-OM
M50×1.5	50	9	15	54	55	9HT RPM.C-M50-C	9HT RPM.C-M50-C-OM
M63×1.5	63	10	16	67	67	9HT RPM.C-M63-C	9HT RPM.C-M63-C-OM



RPM.C-M

- Material : Brass Nickel-plated(C)
- Sealing Material:EPDM,SI.
- IP Grade: Clamping range, O-ring, IP68

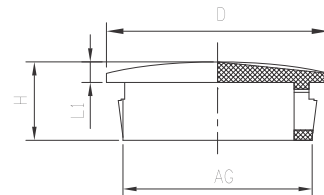

Note:

1) Made under OEM arrangement by reputable cable gland manufacturer

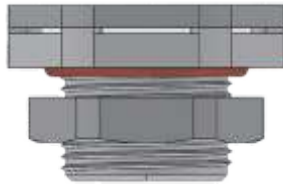

RSV-24 Nylon

- Air Permeability (ml/min@0.07bar): 7500-1900
- Membrane material: ePTFE
- O-ring: Silica gel 60H sjore hardness A
- Flammability UL94: V-0
- Anti-UV: 4-5 Level
- Salt Resistance: 10<0.1%
- Temperature: -40 C~120 C

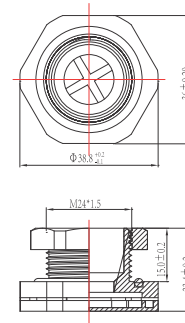

Thread Spec. Specification	Thread OD (AG)	Thread Length (GL)	Hieght (H)	Material Grey RAL 7035	Reference
M24x1.5	24	15	23.4	PA66+25% Glass Fibre	9HTRSV-M24*1.5-IP66

Thread Standard & Installing Hole Opening Data

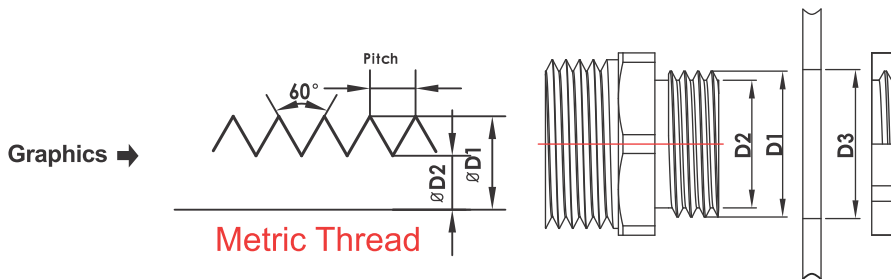

Thread Specification	Pitch	Nominal Size D1	Core Diameter D2	Bore Through D3
M12×1.5	1.5	12	10.5	12-12.5
M16×1.5	1.5	16	14.5	16-16.5
M20×1.5	1.5	20	18.5	20-20.5
M25×1.5	1.5	25	23.5	25-25.5
M32×1.5	1.5	30	30.5	32-32.5
M40× 1.5	1.5	40	38.5	40-40.5
M50×1.5	1.5	50	48.5	50-50.5
M63×1.5	1.5	63	61.5	63-63.5

Note:

1) Made under OEM arrangement by reputable cable gland manufacturer

SINGAPORE 

Schlegel Elektrokontakt Co (FE) Pte Ltd

3015A Ubi Road 1 #06-13/14, Singapore 408705

☎ +65 6841 8691 📠 +65 6841 8693

✉ sales@schlegel.com.sg

🌐 www.schlegel.com.sg

MALAYSIA 

Schlegel Elektrokontakt (M) Sdn Bhd

✉ sales@schlegel.com.my

🌐 www.schlegel.com.my

THAILAND 

Schlegel Elektrokontakt (Thailand) Co., Ltd

✉ setcod@ksc.th.com

INDONESIA 

Partner: **CV. Lestari Electric**

Gedung Lindeteves Trade Center (LTC)

Jl. Hayam Wuruk 127 Lt. UG Blok C.28 no.8-9

Jakarta Barat, DKI Jakarta 11180

☎ 021 2268 2498 / 021 2268 5926

📠 0821 2000 3793

✉ lestari.ltcglodok@gmail.com

VIETNAM 

MYANMAR 

CAMBODIA 

PHILIPPINES 

